

# L017

**SIZE** 17.2mm x 17.2mm x 95.25mm

**CAPACITY** Cup: 10.0mm

**MATERIAL** Top/Cap/Band/Base: ABS  
Sleeve: Aluminum

# Lomei

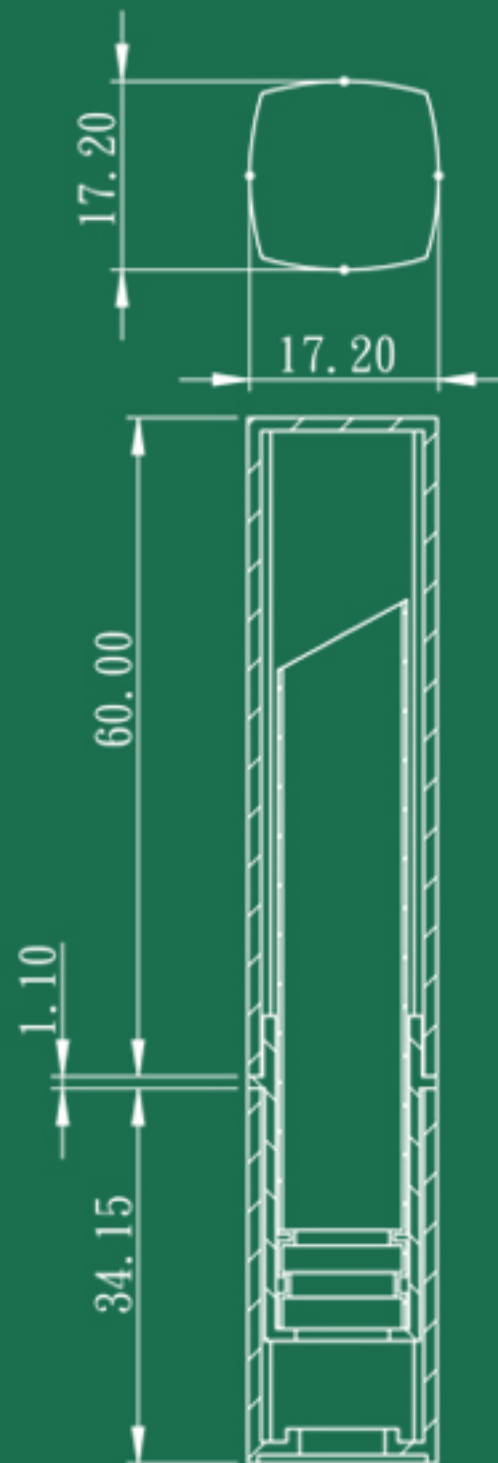

# L019-1

**SIZE**  $\phi 18\text{mm} \times 92.85\text{mm}$

**CAPACITY** Cup: 10.0mm

**MATERIAL** Sleeve: Aluminum / Cap&Base: ABS+AS

Lomei

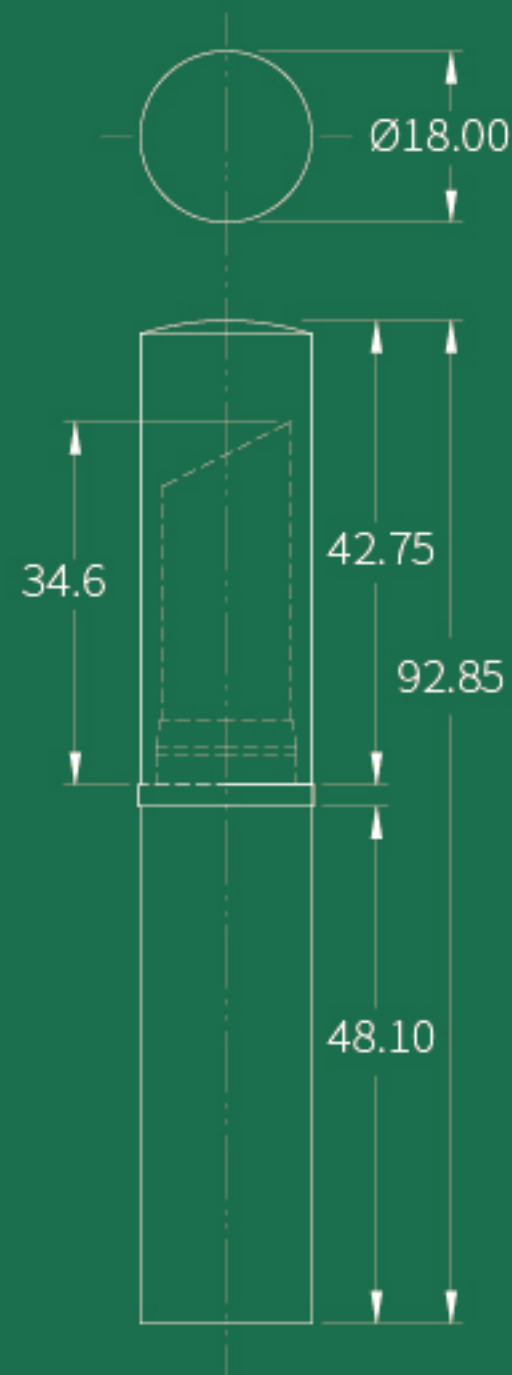

# L120

**SIZE**  $\phi 19.40\text{mm} \times 74.5\text{mm}$

**CAPACITY** Cup: 12.1/12.7mm ( 3.5g )

**MATERIAL** PS

Lomei

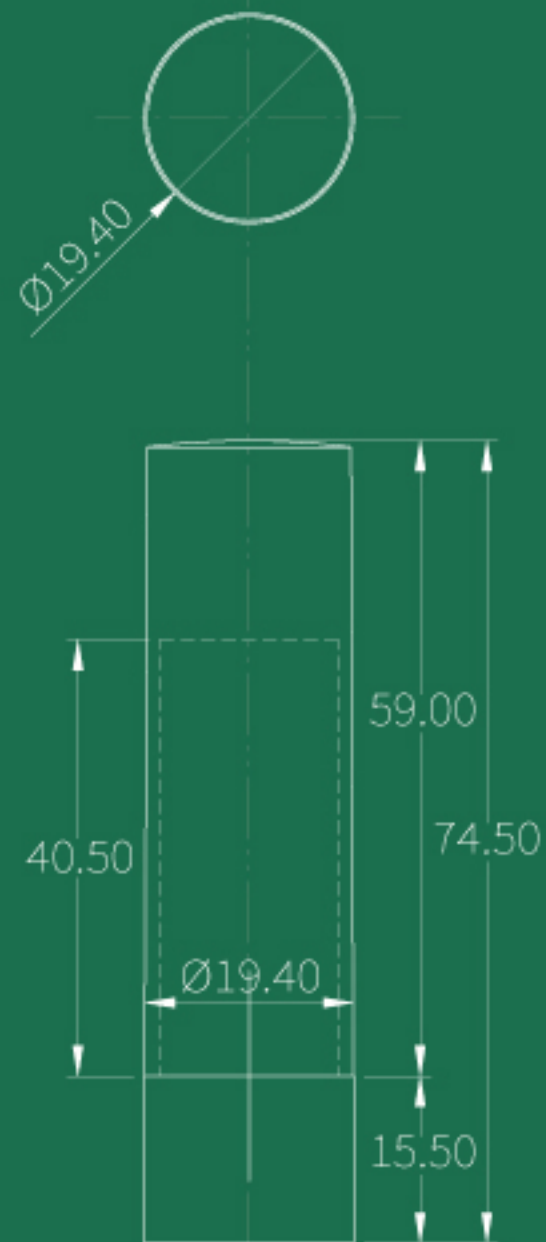

# L120-1

**SIZE**  $\phi 19.65\text{mm} \times 68.55\text{mm}$

**CAPACITY** Cup: 12.1/12.7mm ( 3.5g )

**MATERIAL** PS

Lomei

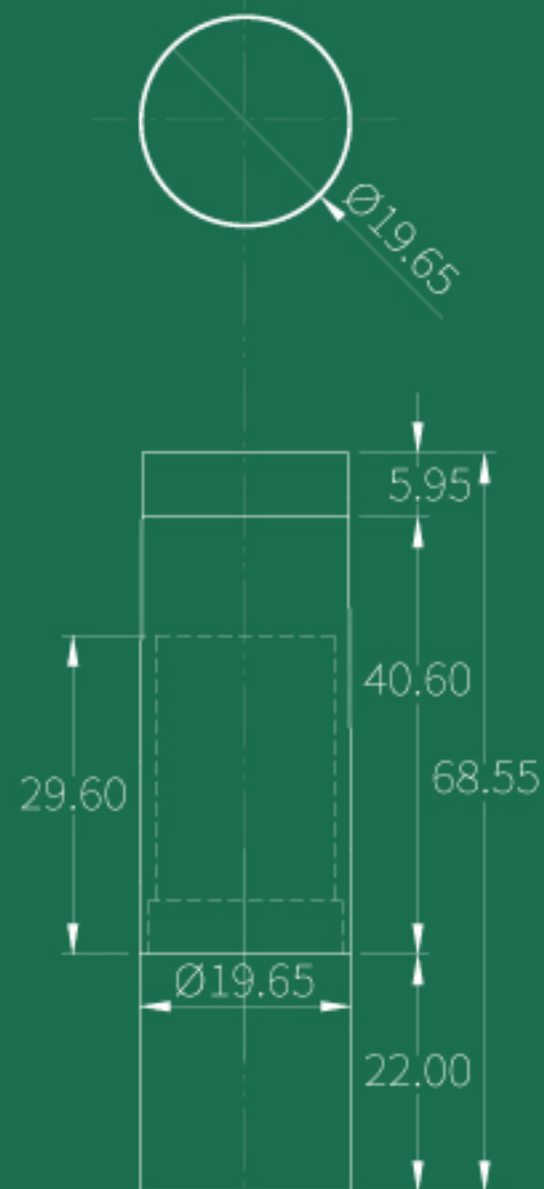

# L120-3

**SIZE**  $\phi 20.1\text{mm} \times 67.5\text{mm}$

**CAPACITY** Cup: 12.1/12.7mm ( 3.5g )

**MATERIAL** Cap/Base/Bottom: SAN | Sleeve: PS

Lomei

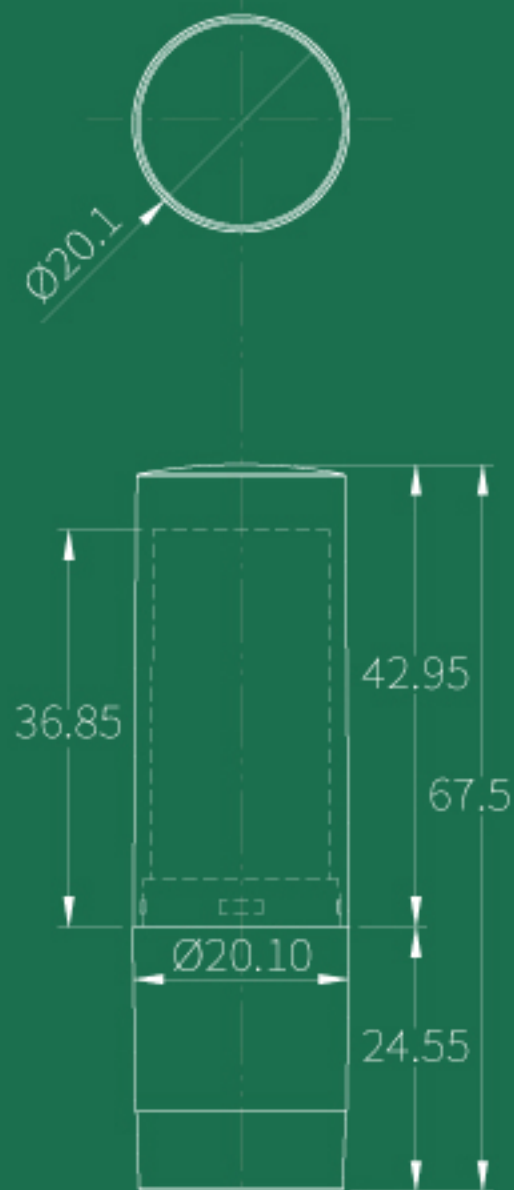

# L130

**SIZE**  $\phi 19.4\text{mm} \times 69.15\text{mm}$

**CAPACITY** Cup: 12.1/12.7mm ( 3.5g )

**MATERIAL** PS

# Lomei

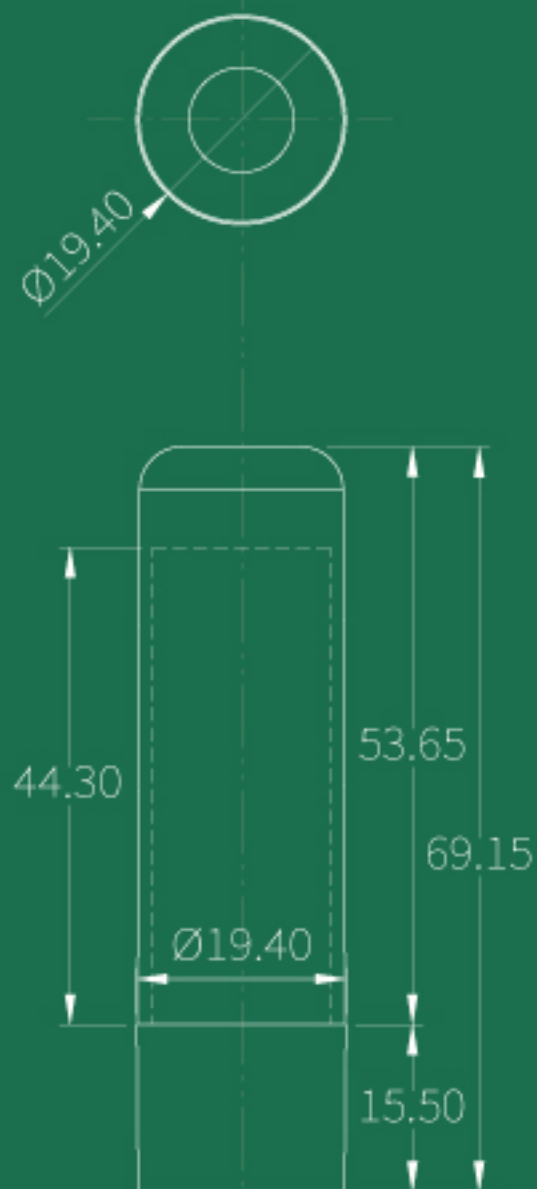

# L130P

**SIZE**  $\phi 19.5\text{mm} \times 74.33\text{mm}$

**CAPACITY** Cup: 12.1/12.7mm ( 3.5g )

**MATERIAL** PS

Lomei

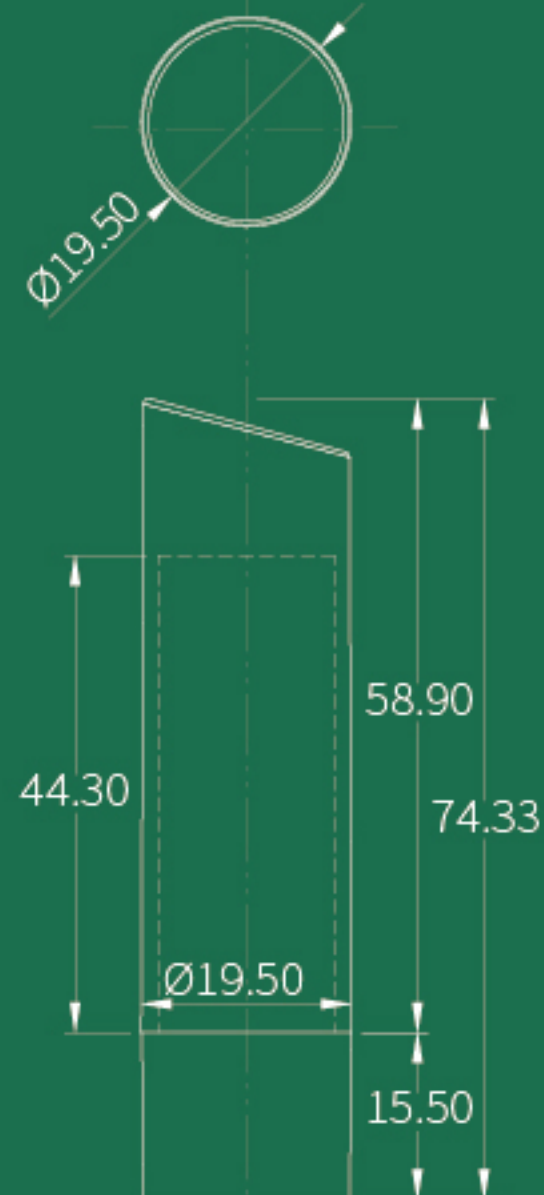



# L150

**SIZE**  $\phi 20.35\text{mm} \times 75.30\text{mm}$

**CAPACITY** Cup: 12.1/12.7mm ( 3.5g )

**MATERIAL** PS

Lomei

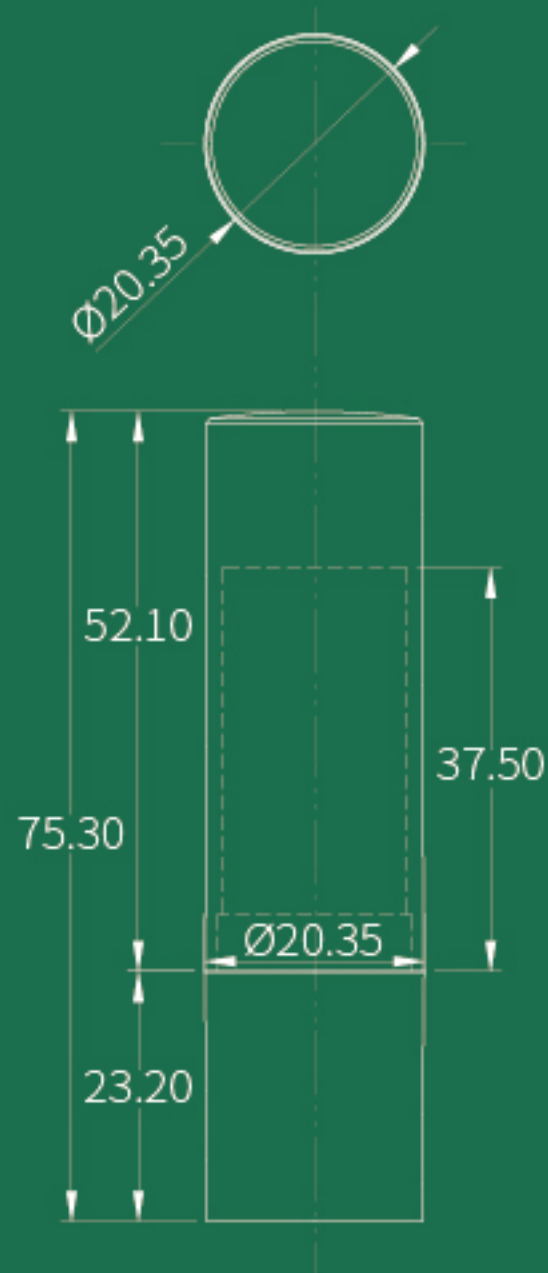



# L170

**SIZE**  $\phi 16.3\text{mm} \times 59.0\text{mm}$

**CAPACITY** Cup: 9mm

**MATERIAL** Cap&Base : ABS

# Lomei

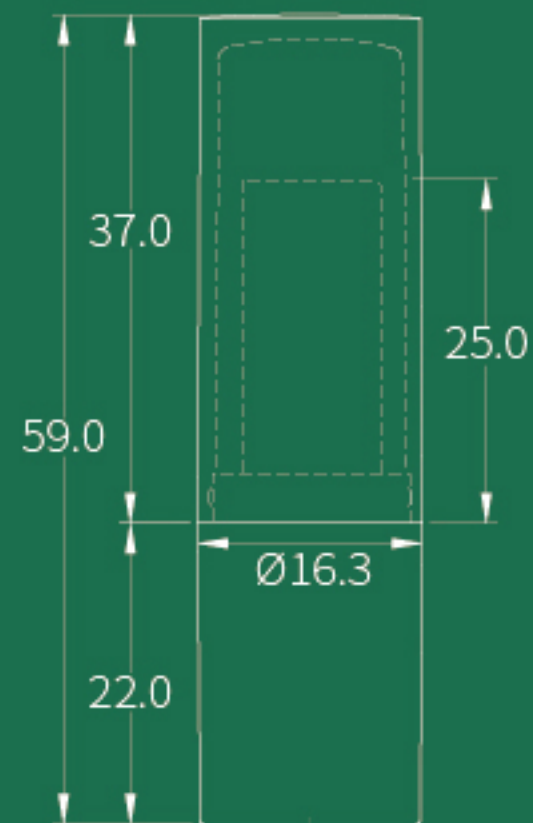

# L318

**SIZE**  $\phi 18.9\text{mm} \times 75.3\text{mm}$

**CAPACITY** Cup: 12.1/12.7mm ( 3.5g )

**MATERIAL** ABS+SAN

# Lomei

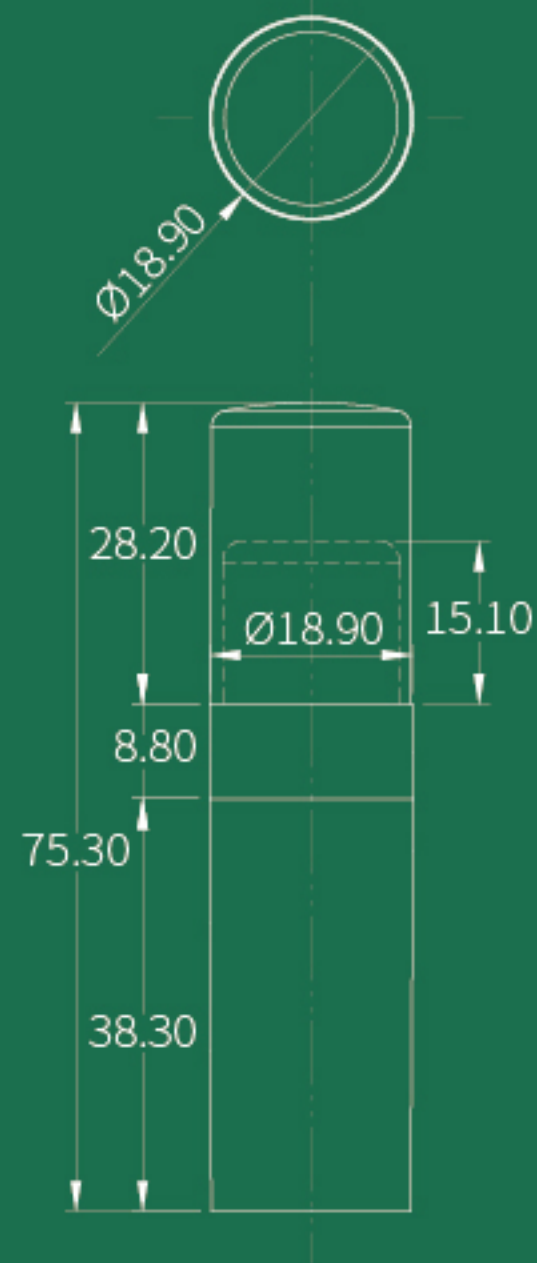

# L332

**SIZE** 19.85mm × 19.85mm × 74.20mm

**CAPACITY** Cup: 12.1/12.7mm ( 3.5g )

**MATERIAL** PS

Lomei

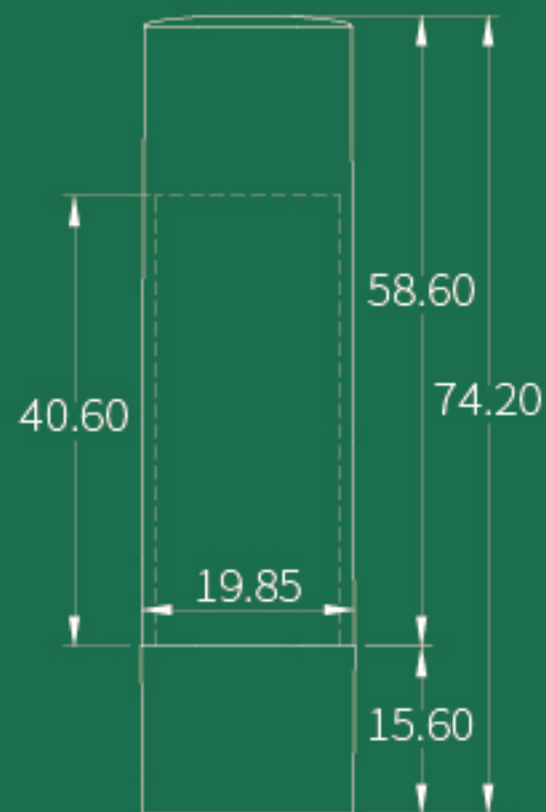
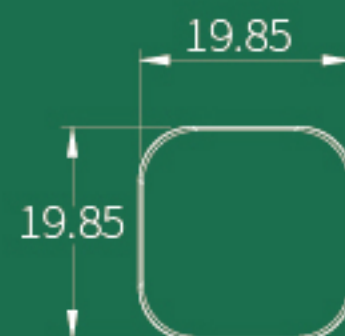

# L332AL

**SIZE** 19.85mm × 19.85mm × 74.20mm

**CAPACITY** Cup: 12.1/12.7mm ( 3.5g )

**MATERIAL** Cap & Base: PS | Sleeve: Aluminum

# Lomei

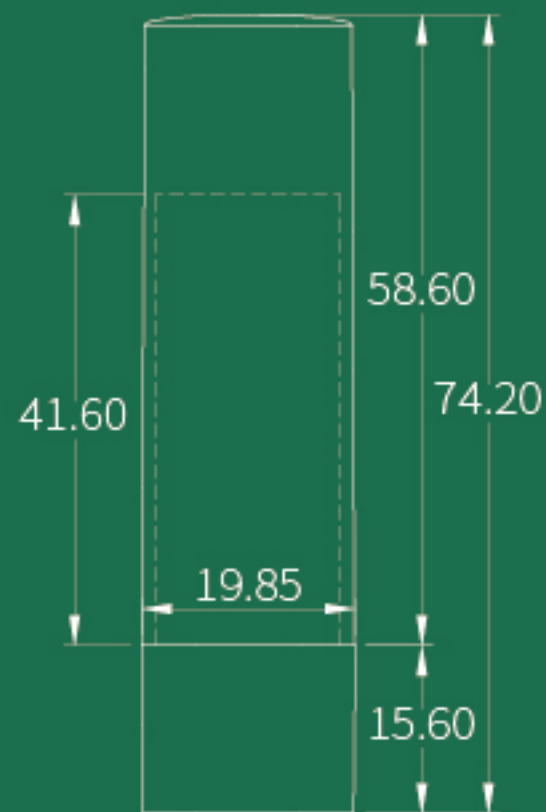
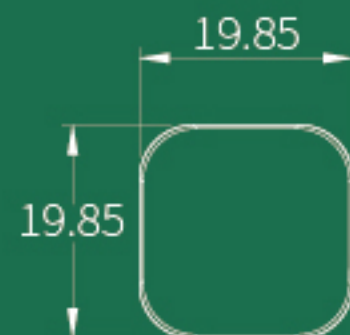

# L333

**SIZE** 20.2mm × 20.2mm × 73.3mm

**CAPACITY** Cup: 12.1

**MATERIAL** Cap: AS | Base: PS

# Lomei

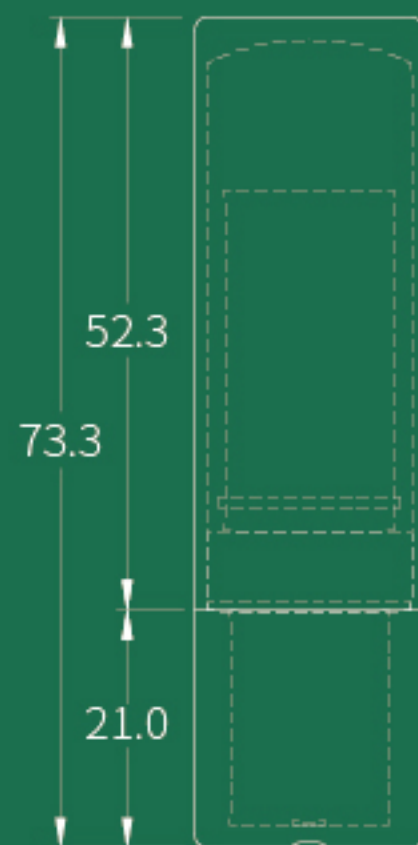
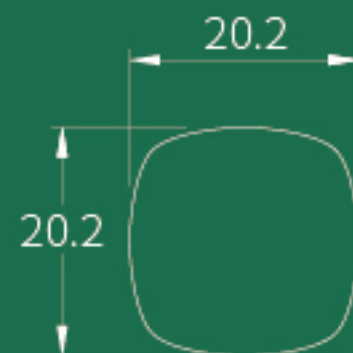

# L336

**SIZE**  $\phi 18.7\text{mm} \times 72.9\text{mm}$

**CAPACITY** Cup: 12.1/12.7mm ( 3.5g )

**MATERIAL** Cap/Base: AS | Sleeve: Aluminum

# Lomei

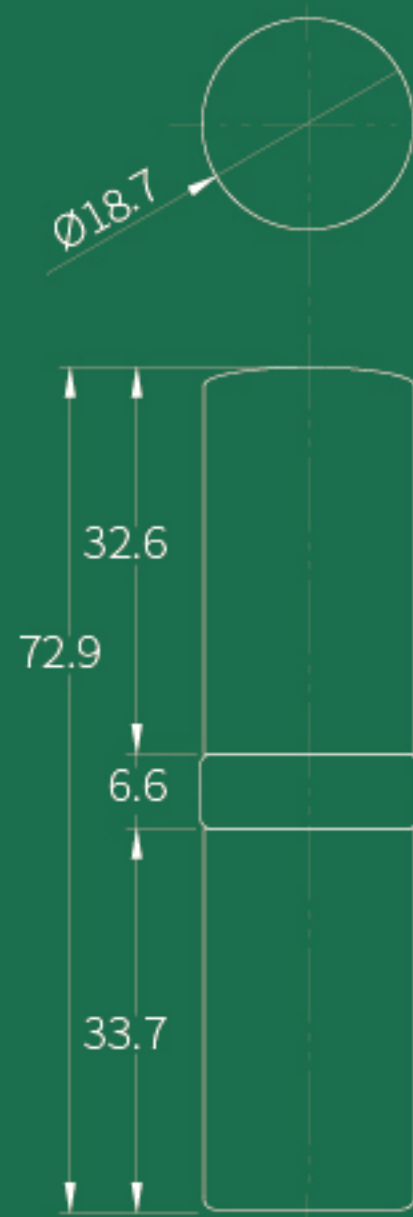



# L383

**SIZE**  $\phi 14.00\text{mm} \times 83.25\text{mm}$

**CAPACITY** Cup: 8.22mm ( 2.8g )

**MATERIAL** Cap/Base: ABS+AS | Sleeve: Aluminum

# Lomei

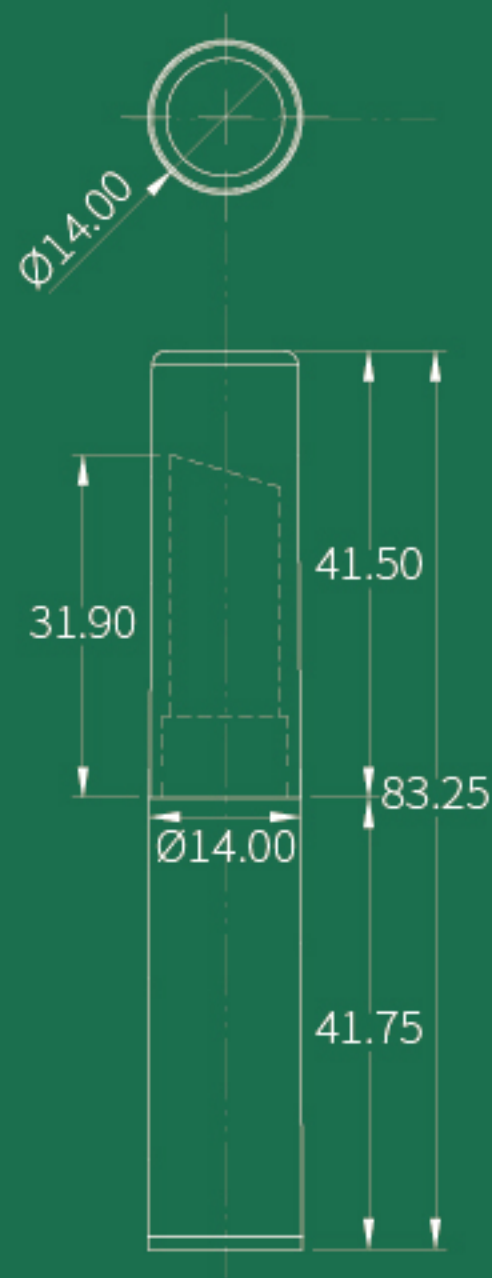

# L789

**SIZE** 22.85mm × 22.85mm × 77.70mm

**CAPACITY** Cup: 12.1mm / 12.7mm ( 3.5g )

**MATERIAL** Cap / Base: PMMA | Band: ABS

# Lomei

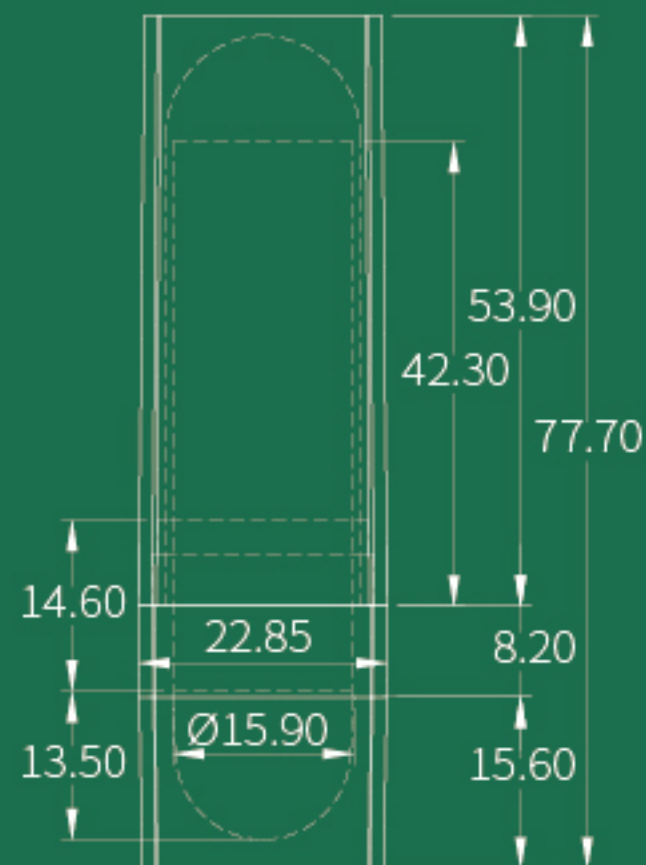
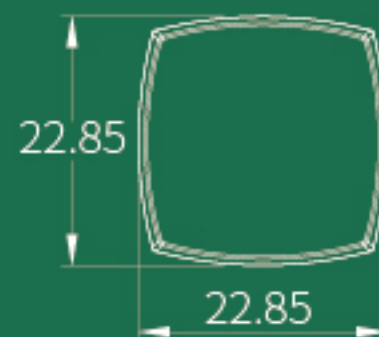

# L789-1

**SIZE** 22.7mm × 22.7mm × 72.5mm

**CAPACITY** Cup: 12.1mm / 12.7mm ( 3.5g )

**MATERIAL** Cap / Band: ABS | Base: PMMA

# Lomei

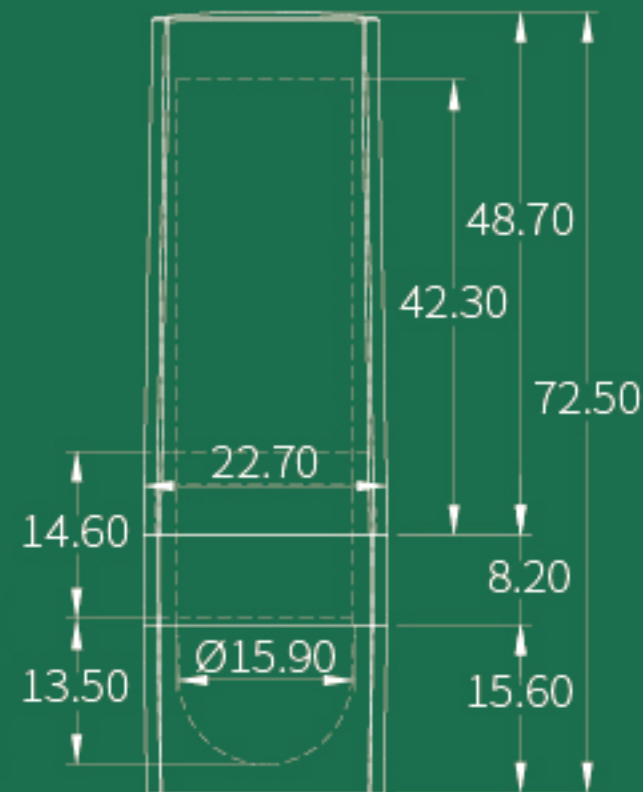
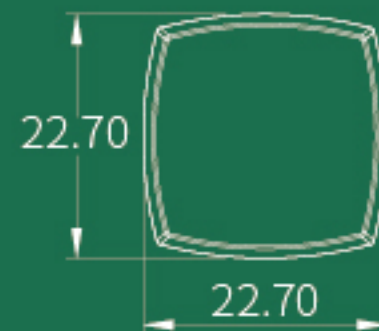

# L869

**SIZE** 22.0 mm × 22.0 mm × 72.0 mm

**CAPACITY** Cup: 12.1mm / 12.7mm ( 3.5g )

**MATERIAL** Cap: ABS / Base: PMMA

# Lomei

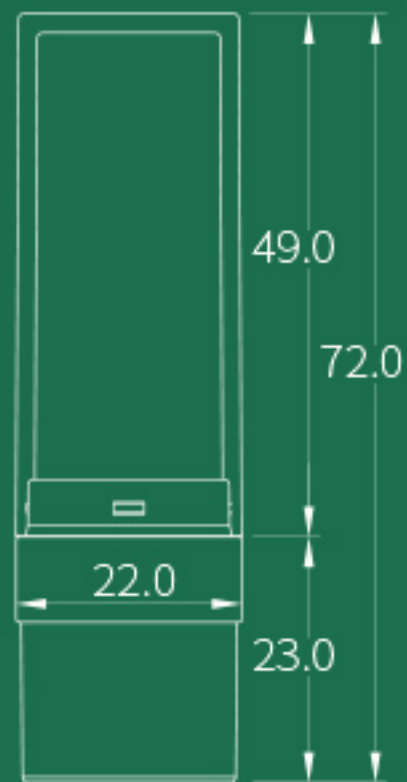
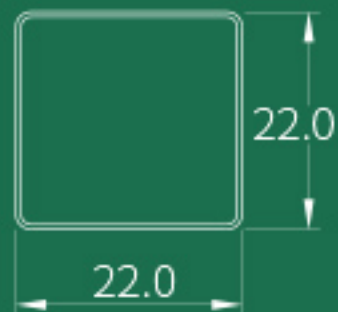

# L869-1

**SIZE** 22.0 mm × 22.0 mm × 72.0 mm

**CAPACITY** Cup: 12.1mm / 12.7mm ( 3.5g )

**MATERIAL** Cap: ABS / Base: PMMA

# Lomei

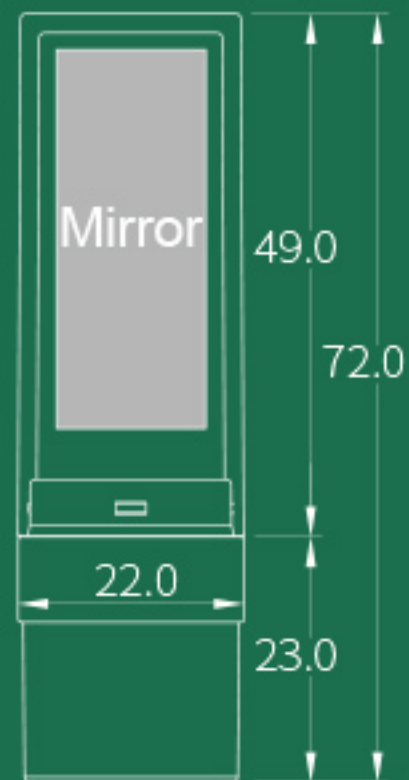
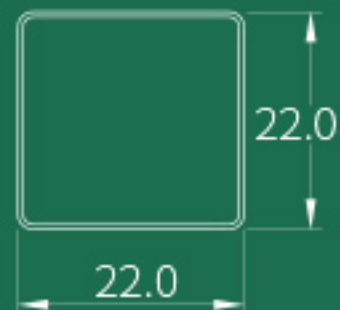



## L869-2

**SIZE** 21.1mm × 21.1mm × 72.8mm

**CAPACITY** Cup: 12.1mm / 12.7mm ( 3.5g )

**MATERIAL** AS

Lomei

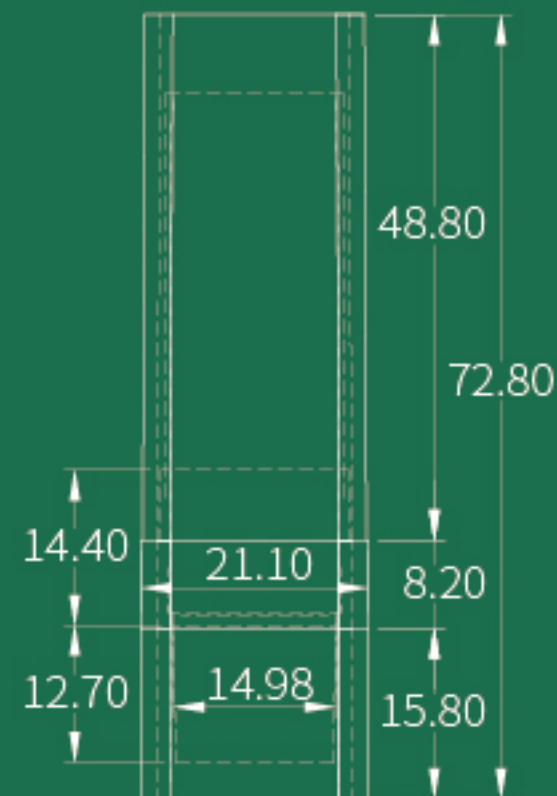
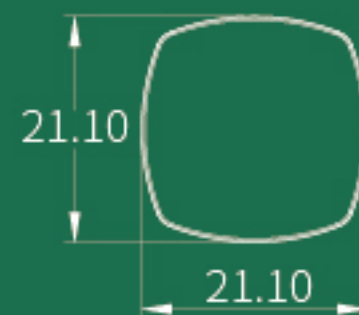



# L2292

**SIZE**  $\phi 22.1\text{mm} \times 74.8\text{mm}$

**CAPACITY** Cup: 12.1mm / 12.7mm ( 3.5g )

**MATERIAL** Cap: ABS / Base: PMMA

# Lomei

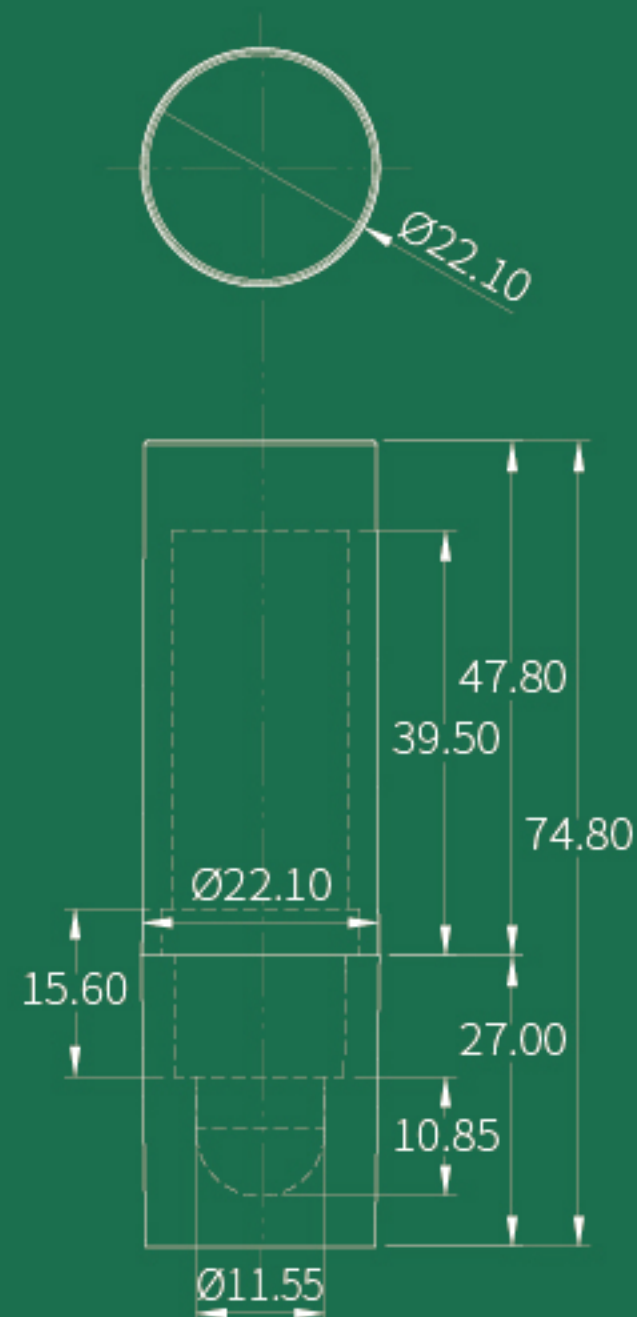

# L2292-1

**SIZE**  $\phi 22.10\text{mm} \times 75.25\text{mm}$

**CAPACITY** Cup: 12.1mm / 12.7mm ( 3.5g )

**MATERIAL** Cap: ABS / Base: PMMA

Lomei

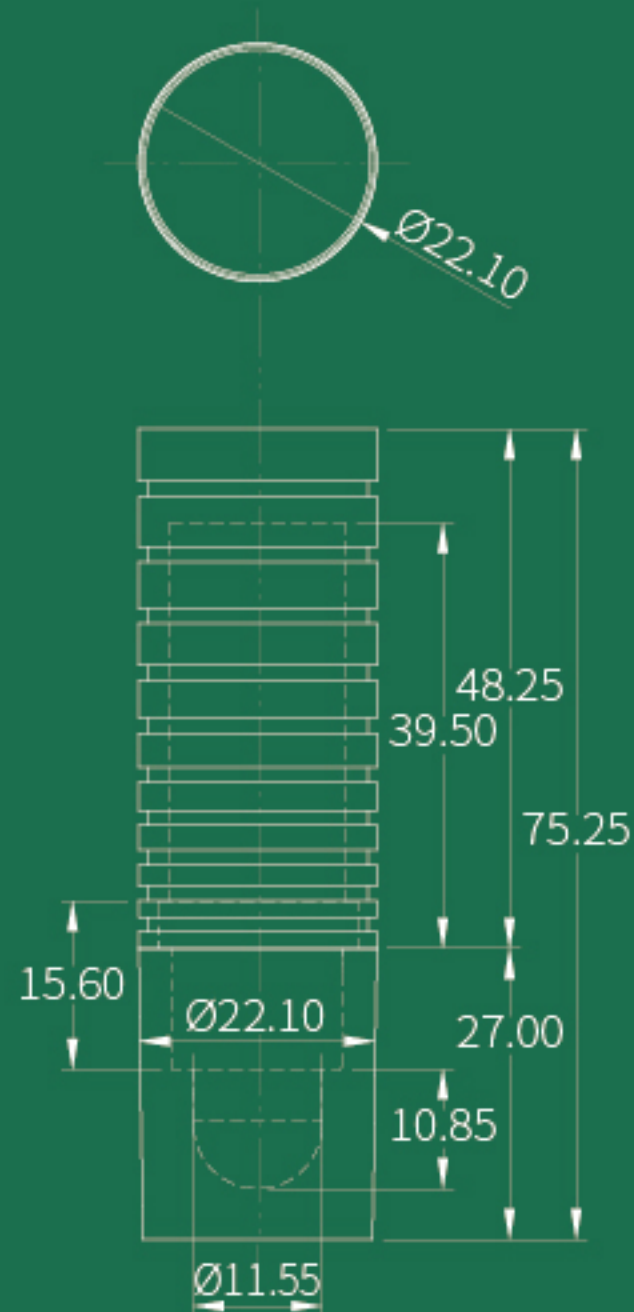

# L2292-2

**SIZE**  $\phi 22.20\text{mm} \times 72.90\text{mm}$

**CAPACITY** Cup: 12.1mm / 12.7mm ( 3.5g )

**MATERIAL** AS

# Lomei

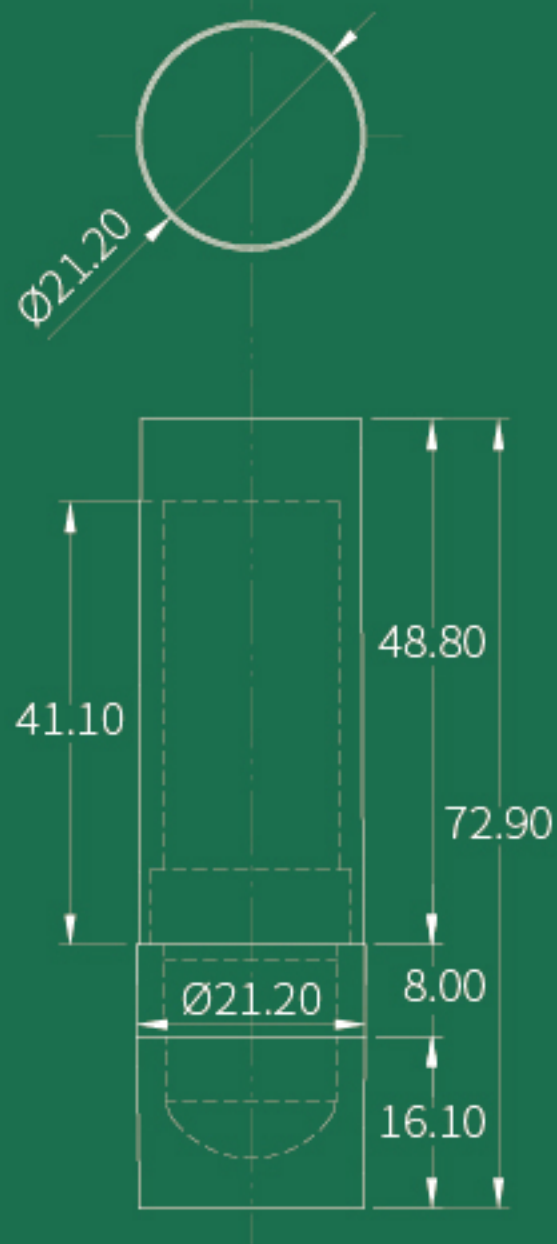

# LM029

**SIZE** 20.00mm × 20.00mm × 71.85mm

**CAPACITY** 3.5g

**MATERIAL** AS

Lomei

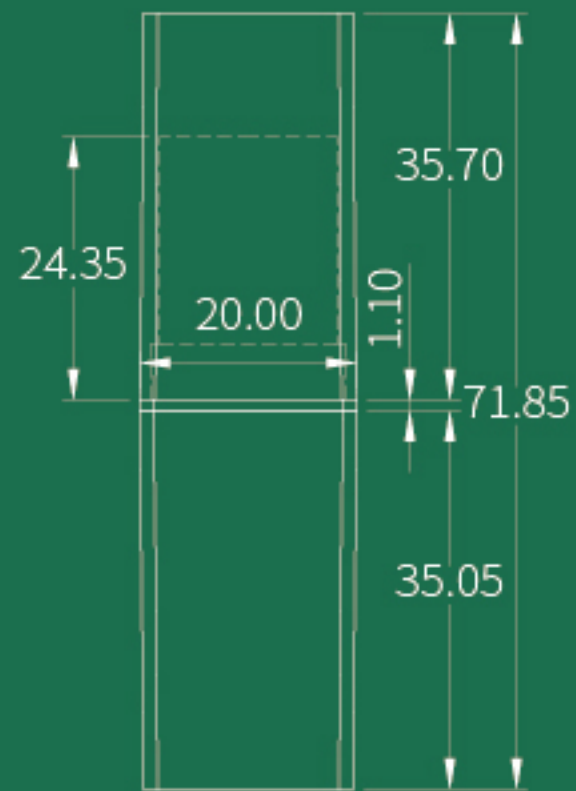
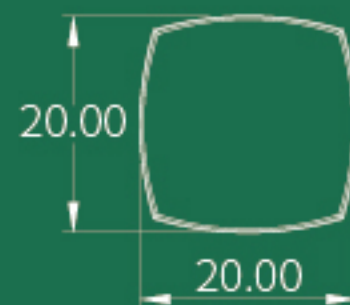

# LM180

**SIZE**  $\phi 17.15\text{mm} \times 88.10\text{mm}$

**CAPACITY** Cup: 11.7 mm

**MATERIAL** Cap: AS / Base: ABS

Lomei

