

LM52

SIZE $\phi 18.60$ mm \times 94.15 mm

CAPACITY 4.5 g

MATERIAL Cap: ABS / Bottle : PETG / Stem: PP / Wiper: PE

Lomei

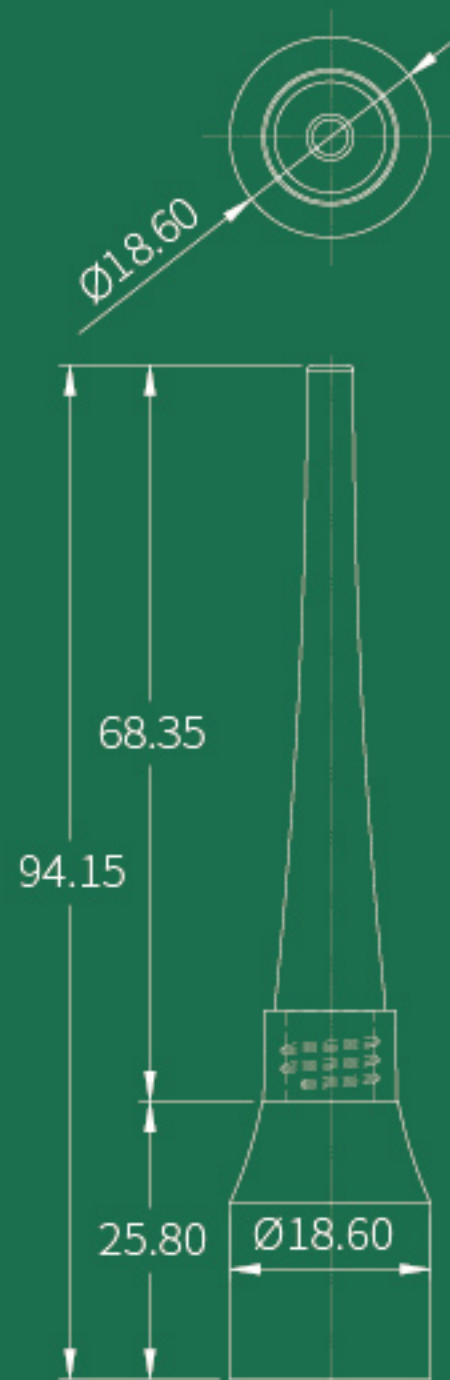

LM56

SIZE 19.9mm × 16.0mm × 96.3mm

CAPACITY 6g

MATERIAL Cap: ABS / Bottle:PETG / Stem: PP / Wiper: PE

Lomei

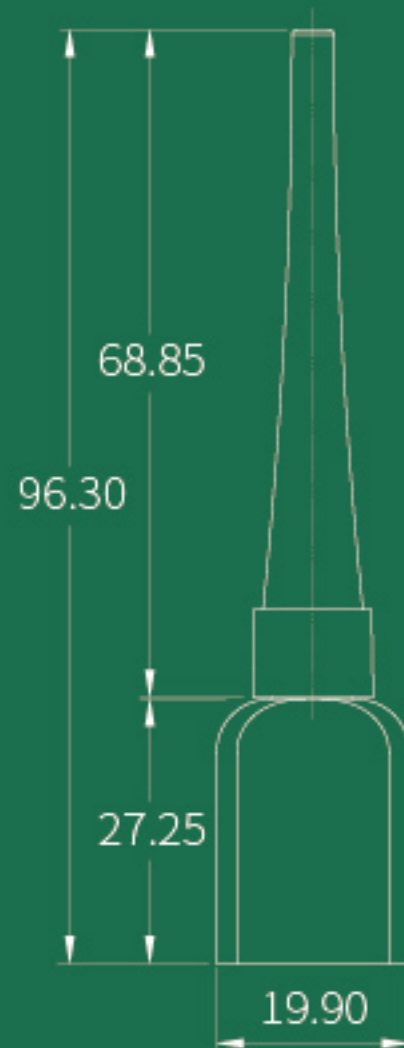
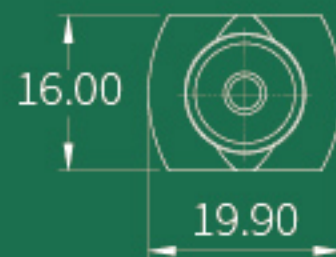

LM57

SIZE 19.3 mm × 19.3 mm × 96.6 mm

CAPACITY

MATERIAL Cap: ABS / Bottle:PETG

Lomei

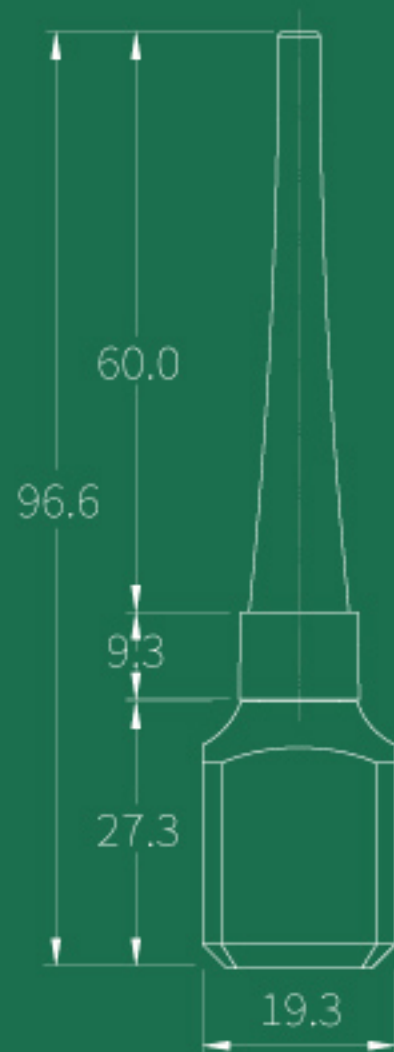
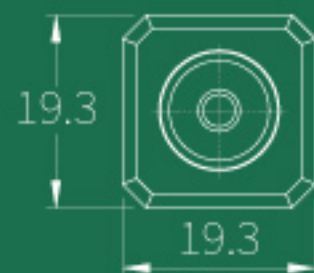

LM93

SIZE $\phi 16.8\text{mm} \times 101.9\text{mm}$

CAPACITY 4.5g

MATERIAL Cap: ABS / Bottle : PETG | Stem: PP / Wiper: PE

Lomei

